

BALTIMORE COUNTY

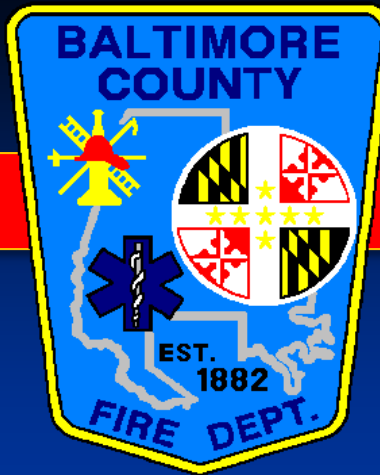

FIRE DEPARTMENT

# ROADWAY SAFETY



# 2019

- 18 Law enforcement
- 17 Tow operators
- 9 Fire/EMS personnel



# 2020

- 10 Law enforcement
- 6 Tow operators
- 3 Fire/EMS personnel
- 1 DOT worker



# Roadway Safety

- 12,200 roadway incident responses DAILY
- BCoFD 2019
  - 2,419
- Top 3 causes of roadway incidents



# Roadway Safety

- Involved in accident/emergency
  - Location
  - Safe area
  - Safe movements



# Roadway Safety

- Approaching an emergency scene/construction
  - Slow down, move over
  - HAAS incident alerting (GPS)



# Roadway Safety

- Scene safety/apparatus position
- Safety enhancements (new apparatus)
- Traffic Incident Management Area (TIMA) set-up





**Entrance or  
On Ramp**

**Left or Inside  
Shoulder**

**Right or Outside  
Shoulder**

**Left Lane  
or Lane 1**

**Right Lane  
or Lane 4**

**Left Center  
or Lane 2**

**Right Center  
or Lane 3**

Photo by Ron Moore,  
McKinney (TX) Fire Dept.





# Traffic Incident Management Area (TIMA)

also known as a Temporary Traffic Control Zone (TTC)

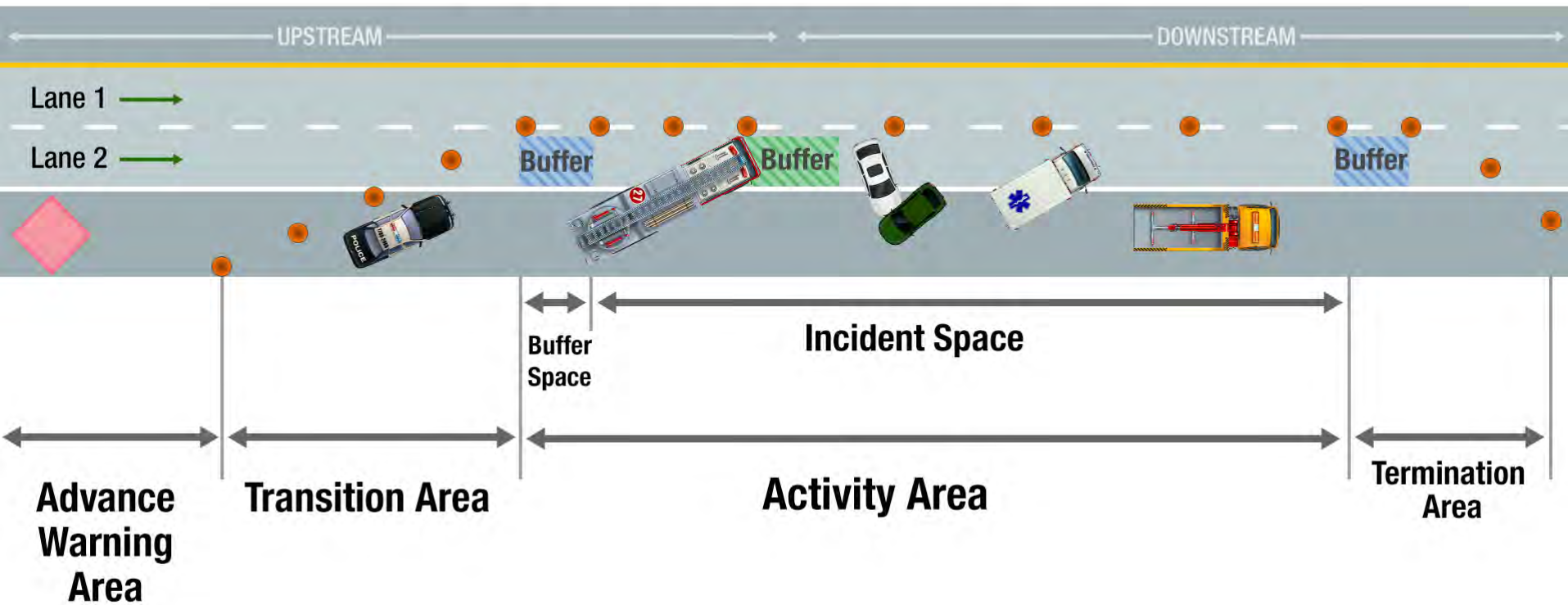



# BALTIMORE COUNTY FIRE DEPARTMENT



## ROADWAY INCIDENT TACTICAL CARD

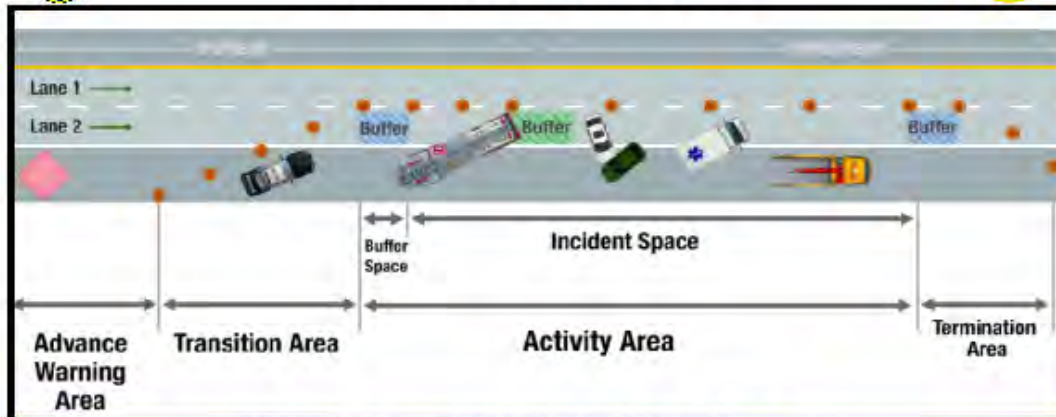

### TEMPORARY TRAFFIC CONTROL ZONE

ADVANCE WARNING AREA		INITIAL FIRE UNIT(S)	INITIAL EMS UNIT(S)	SECONDARY FIRE UNIT(S)
MPH	DISTANCE	ACTIONS	ACTIONS	ACTIONS
40	320 ft.	Position at angle to deflect traffic	Position downstream and within the protective envelope of the fire unit	Position upstream of the incident to provide advance warning using the chart on the left
55	440 ft.			
65	520 ft.	Communicate lane/shoulder position of incident to incoming units	Angle rear of unit away from active traffic lanes for safe patient loading units	Position at angle to deflect traffic. Avoid use of rear facing scene lights that may blind drivers
70	560 ft.			

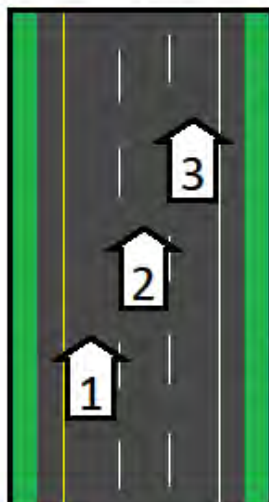

Designate a spotter	Remain on the roadway only as long as needed to stabilize the patient. Exit highways and continue treatment/evaluation on a secondary roadway/parking lot	
Request additional resources (CHART, etc)		

**\*Minor apparatus (DC/BC/EMS cars, utilities, brush units, etc.) do not provide adequate blocking protection and should be positioned downstream of the blocker\***



# Firefighter Safety Stand Down

2020 FIREFIGHTER  
**SAFETY**  
STAND DOWN



<https://www.safetystanddown.org/>



BALTIMORE COUNTY FIRE DEPARTMENT

Captain Scott Ebbert

[sebbert@baltimorecountymd.gov](mailto:sebbert@baltimorecountymd.gov)

410-887-0069

410-887-7556

